

# TASK MASTER II™ DISCONTINUED

## 1 ½ INCH COMMERCIAL INDUSTRIAL WATER SOFTENER AND FILTER VALVE

APPLICATION: TOP MOUNTED IN WATER KING RF SERIES

SIDE MOUNTED IN WATER KING MF SERIES

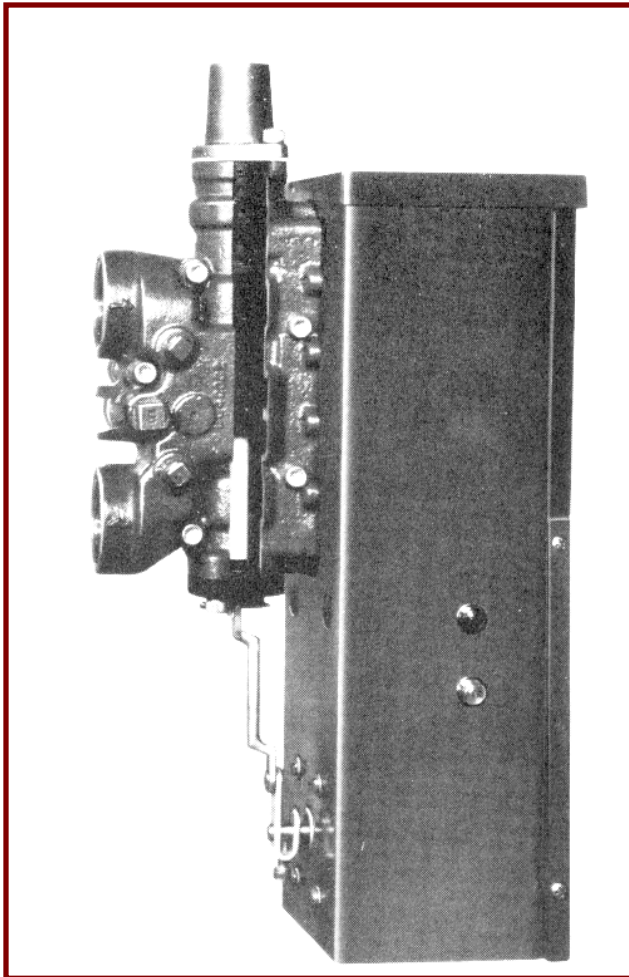

- The Task Master II™ is a brass, 1 ½ inch, five cycle, water softener control valve.
  - There is only one moving part – the piston.
  - The valve body is all brass and the piston is stainless steel with Buna-n seals and Noryl® inserts.
  - The valve has two different tank adaptors allowing top mount on a fiberglass tank or side mount on the face piping of a steel tank.
  - The housing for the brine ejector is cast into the valve body making it an integral part of the valve.
  - The piston is motor driven and is not dependent on water pressure. It shifts smoothly without water hammer. The drive assembly positions the plunger for each of the five cycles.
  - The valve design assures synchronization of the drive assembly with the timer making certain the plunger is correctly positioned for each of the five cycles of softening.
  - The valve design allows up to 70 gpm of by-pass flow during regeneration.
  - The electrical enclosure carries a NEMA 3 rating providing rainproof protection for electrical components.
  - The valve includes "Service" and "Regeneration" indicator lights.
- Since brining and process control often must be coordinated with the regeneration cycles of a softener, the valve is designed to provide an on/off signal and dry contacts for external electrical functions. Standard models include a 6-day timer.

**FOR REPLACEMENT VALVES SEE CAT315 TASKMASTER III**

## CAT310.2

### SPECIFICATIONS - DISCONTINUED

#### Control

### FOR REPLACEMENT VALVES SEE CAT315 TASKMASTER III

- The control valve shall be one (1) Task Master II™ 5-Cycle, 100 psi, multi-port control valve(s) with machined brass body, stainless steel piston assembly, Noryl® inserts, Buna-N seals, service and regeneration lights, drive motor assembly, and NEMA 3 enclosure (120VAC/60Hz/3Amps).
- The valve shall operate with a single motor driven, cam positioned piston. Maximum operating pressure of the valve shall be 100 psi. The valve shall be of a single piston design and not use multiple plungers or diaphragm valves.
- Each control valve shall be equipped with "Service" and "Regeneration" indicator lights.
- Hard water by-pass shall be available during all regeneration cycles at 70 gpm or at the peak flow rate of the unit, at a pressure drop less than 25 psi, whichever is less.
- The valve shall be equipped with threaded ¼" FNPT ports for the installation of sample taps and pressure gauges. (Taps and gauges are optional.)

VALVE MODEL	PART NO.
<b>RF TOP MOUNT</b>	
RF-45-1½"	707203-38
RF-50-1 ½"	707203-39
RF-70-1½"	707203-39
RF-100-1½"	707203-40
RF-120-1½"	707203-41
RF-150-1½"	707203-42
RF-240-1½"	707203-43
RF-300-1½"	707203-44
RF-450-1½"	707203-45
<b>MF SIDE MOUNT</b>	
MF-120-1½"	707203-74
MF-150-1½"	707203-75
MF-180-1½"	707203-76
MF-200-1½"	707203-77
MF-225-1½"	707203-78
MF-240-1½"	707203-79
MF-300-1½"	707203-80
MF-450-1½"	707203-81
MF-600-1½"	707203-82
MF-750-1½"	707203-83
<b>MF MM FILTER</b>	
FMF 150-1½-MM	940056-3-3
<b>RF FILTER</b>	
FRF 70-1½-T, -C	707203-1
FRF 70-1½-S	707203-2
FRF 70-1½-I	707203-4
FRF 120-1½-T, -C, -S	707203-3
FRF 120-1½-I	707203-5
FRF 150-1½-T, -C	707203-6
FRF 150-1½-S	707203-7
FRF 150-1½-I	707203-8
<b>MF FILTER</b>	
FMF 240-1½-T, -C	707203-9
FMF 240-1½-S	707203-10
FMF 240-1½-I	707203-11
FMF 300-1½-C	707203-12
<b>RF MM FILTER</b>	
FRF 45-1½-MM	940050-3-3
FRF 50-1 ½-MM	940051-3-3
FRF 70-1½-MM	940051-3-3
FRF 100-1½-MM	940052-3-3
FRF 120-1½-MM	940053-3-3
FRF 150-1½-MM	940054-3-3

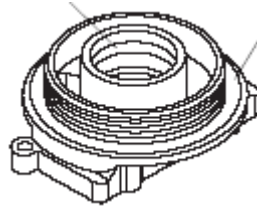

Top Mount  
Tank Adaptor

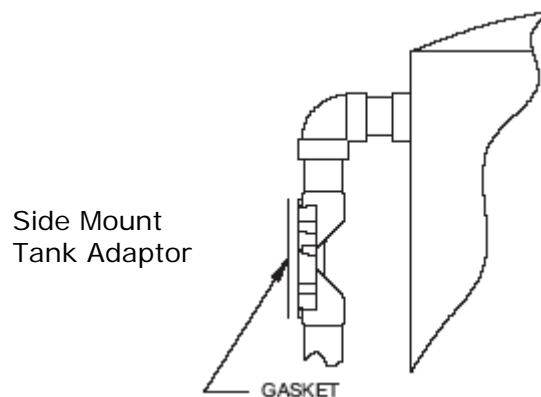

Side Mount  
Tank Adaptor